

FREE

# Our REDLANDS coast

WINTER 2020

## Artbeat

Culture and creativity  
from the heart! P4-5

## Plus

Your division in focus

This magazine's wrap has been made using an additive which causes it to biodegrade.



Redlands  
coast



Redland  
CITY COUNCIL



## What's inside

### p4-5 Way to our heART

Redlands Coast's network of art trails lead to a creative and cultural experience.



### p6-7 IndigiScapes

Check out the wonderful world of opportunities at Council's rejuvenated IndigiScapes centre.



### p8-13 Moving again

Council's budget for 2020-21 targets jobs, essential infrastructure and community services.



### p28-29 On stage

RPAC is back with a top-class program of touring shows.



### p30 Oh my word!

Membership of your local Council library is free and full of exciting possibilities.



#### OUR COVER:

Quandamooka traditional owner Matthew Burns shares his rich heritage on North Stradbroke Island/Minjerribah.  
Photo: Nathan McNeil



IF YOU NEED ASSISTANCE ... talk with a member of Council's friendly customer service team by calling 3829 8999.

#### Credits:

##### Published by:

Redland City Council  
redland.qld.gov.au

##### Editor:

Mark Voisey  
mark.voisey@redland.qld.gov.au

##### Digital editor :

Jason Brisbane

##### Stories and photos:

Sharon Bird, Cheryl Gray, Amy Hood, Jeannine Meyer, Caryn Puljic, Lyn Uhlmann, Mark Voisey, Penny Whitehouse, Susie Winter

##### Design and graphics:

Allan Shephard, Stacie Rule

This magazine's oxo-biodegradable plastic wrap has been made using the TDPA™ additive that promotes the degradation of single-use plastics.

Division 1  
Wellington Point and  
Ormiston  
Cr Wendy Boglary

Division 3  
Cleveland, Thornlands  
and Victoria Point  
Cr Paul Gollé

Division 5  
Redland Bay and Bay  
Islands  
Cr Mark Edwards

Division 7  
Alexandra Hills,  
Capalaba, Thornlands and Cleveland  
Cr Rowanne McKenzie

Division 9  
Sheldon, Capalaba  
and Thornlands  
Cr Adelia Berridge

Division 2  
Cleveland and North  
Stradbroke Island  
Cr Peter Mitchell

Division 4  
Victoria Point,  
Coochiemudlo Island,  
Redland Bay  
Cr Lance Hewlett

Division 6  
Mt Cotton and  
Redland Bay  
Cr Julie Talty

Division 8  
Birkdale, Alexandra Hills,  
Capalaba and  
Wellington Point  
Cr Tracey Huges

Division 10  
Birkdale  
and Thornside  
Cr Paul Bishop





## Message from the Mayor

Congratulations Redlands Coast! The way you have continued to rally to keep our community safe since COVID-19 emerged six months ago is quite exceptional.

How we have cared for each other through practising social distancing and complying with health directives, as well as accepting and supporting measures to restrict the spread of coronavirus, really is a hallmark of the Redlands Coast way of life.

As recently seen, the pandemic is far from over and the effects will last for some time yet.

People have lost their jobs and businesses have suffered as a direct result of the coronavirus and your Council is now working to repair that and restart our local economy to provide new opportunities.

We are urging everyone in our community to “buy local” and wherever possible support local businesses to protect and create local jobs.

As one of Redland Coast’s largest employers, we are taking up the challenge by ensuring that we spend locally to create local jobs.

That’s why Restarting Redlands Coast is at the heart of Council’s record \$327 million budget for 2020-21 which provides a \$3 million safety net for those most impacted by the pandemic.

While Council’s finances have taken a multi-million-dollar hit, this year’s budget includes an expanded \$80 million capital investment in the city aimed at generating and preserving local jobs and adding to and sustaining vital community infrastructure and services. A significant part of this record spend is thanks to the strong financial reserves that we built for a situation such as this.

Council’s \$3 million COVID support packages have already benefited close to 100 businesses directly with grants topping \$370,000 and many more indirectly via business advice and assistance in accessing state and federal support packages from Council’s dedicated business support officers, who have also been helping social enterprises, community groups and sporting clubs.

We are also working compassionately with residents, businesses and clubs seeking financial relief.

The full impacts of the COVID pandemic won’t be known until after support such as the Federal Government’s Job Keeper program have ended, which is why as part of this year’s budget, Council adopted a deliberate strategy of putting \$1 million aside to provide relief when that need is better understood. This may be through rates relief, further business support or grants to the

community; we will keep an eye on the impacts and have that money on hand to respond when and where it is needed most.

Along with our local chamber of commerce and business groups, we continue to work with the state and federal governments to bring forward shovel-ready projects for Redlands Coast. That effort is already proving fruitful and we want as much of this work as possible to go to local firms and local workers.

The likelihood is that domestic travel, particularly to Queensland, will be in vogue for some time yet and we are well placed to tap into that market with Council launching a major campaign, *Reconnect on Redlands Coast*, to attract visitors to our naturally wonderful city, especially from the greater Brisbane area.

Councillors are united in their deep commitment to steering us through these times and I have no doubt that, by working together, buying local together and continuing to care for each other the way we have, we will emerge stronger and even more resilient.

Regards,

**Mayor Karen Williams**

E: [mayor@redland.qld.gov.au](mailto:mayor@redland.qld.gov.au)



# The heART of Redlands Coast

Mainland and island trails lead to a creative experience

Art lovers and those who enjoy discovering hidden gems will delight in the new Redlands Coast Art Trails.

Redland City Council's collection of more than 100 public art works include vibrant and intriguing creations that reflect the history, culture and stories of Redlands Coast. Take a day or spend a week discovering the naturally wonderful talent and culture featured through a network of art trails.

## Cleveland (Nandeebie) to North Stradbroke Island (Minjerribah)

You can join the trail at any point or start by picking up the new Art Trail brochure from the Redlands Coast Visitor

Information Centre at the Raby Bay Harbour Precinct or by checking out [redland.qld.gov.au/ArtTrails](http://redland.qld.gov.au/ArtTrails).

Head towards Cleveland town centre and you'll pass large-scale sculptures, including *Marine Sail* in sandstone and bronze and *Mud Flats*, a concrete and stainless-steel water feature, before reaching Cleveland Library on Middle Street.

Don't forget to look down - you'll notice decorated service pit covers and inlaid mosaics along the trail, built into garden beds and as part of street furniture.

Redland Art Gallery, on the corner of Middle and Bloomfield streets, features more than 830 artworks in its collection, created by 220 artists, including early settler and Aboriginal and Torres Strait Islander artists. Information on gallery exhibitions and opening hours is at [artgallery.redland.qld.gov.au](http://artgallery.redland.qld.gov.au)

Look across Middle Street from the gallery towards the library building for best views of the Dabilbahna (Salt Water Country) wall mural, one of several important place markers in Quandamooka Country.

Stroll down Bloomfield Street and discover Queensland's first Poetry Trail, including contributions honouring Oodgeroo Noonuccal (Kath Walker), with contemporary artworks built into the townscape. Bloomfield Park features a popular children's play sculpture.

From Cleveland town centre, the trail returns to Middle Street before branching towards Cleveland Point or connecting via ferry services to North Stradbroke Island (Minjerribah).

The Cleveland Point trail takes in The Old Schoolhouse Gallery, at 124-126 Shore Street North where you can take a closer look at exceptional Redlands Coast art and creative talent.

North Stradbroke Island (Minjerribah) reveals its rich Quandamooka history and culture through art and place marking. Explore three art galleries at Dunwich (Goompi) featuring work by local artists. Look for the whale (Yalingbila) mural to



locate the North Stradbroke Island Arts Collective (upper level), selling work by several local artists. It's just a short stroll to the Salt Water Murris Quandamooka Art Gallery and the studio of renowned artist Delvene Cockatoo-Collins (pictured below).

The refurbished reception of the North Stradbroke Island Museum, in Welsby Street, is to feature wall art by Quandamooka artist Megan Cope and others as a cultural backdrop for the museum's reflection of life and issues before, during and after European colonisation.

Ask the helpful museum staff about some of Minjerribah's earlier public art spaces and you'll discover historic wall art that reflect important social and political developments on the island.

If you head to the island's north-east you will discover two of Redlands Coast's most recent public art installations.

Quandamooka artists Belinda Close and Delvene Cockatoo-Collins were inspired by storylines and the living environment when creating place markers at Amity Point (Pulan Pulan) and Point Lookout (Mooloomba). Delvene's *Eugaries* at Point Lookout signifies the importance of the eugarie as a food source, while Belinda's *Mirriginpah* tells the story of the sea eagle.

Stop off at the Point Lookout Community Hall and Library to discover Michael Bulloch's *Monumental Lab Whale*



emerging from the undergrowth on the shore side of the building.

Other local art is on display at Point Lookout at Starfish Studio and at Julie Sisco Photography, part of the Anchorage resort building. There's so much history, culture and art to take in, not to mention Minjerribah's naturally wonderful beaches and island lifestyle. You may never want to leave.

## Southern Moreton Bay Islands (SMBI) Art Trail



The four islands collectively known as the Southern Moreton Bay Islands are a haven for artists and creatives. As well as being home to hundreds of talented resident artists, the islands of Macleay (Jencoomercha), Karragarra, Lamb (Ngudooroo) and Russell (Canaipa) feature private art collections, galleries and public art installations.

The Redlands Coast Southern Islands Sculpture Trail had its origins in the Girt By Sea outdoor sculpture exhibition and competition in 2016.

Prize-winning works by Darren Goleby, Ted Upton and Rod Hammond have been installed on Macleay Island. Other prize-winning works including Mike Van Dam's *Dolphins* and Christopher Trotter's *Sonnie Bay Buoy* can be found on the Karragarra Island foreshore, with public art sculptures also at Russell Island's Jock Kennedy Park and Lamb Island's Pioneer Park. Largely made from natural or recycled materials, expressing a sensitivity to the environment with wit, whimsy and humour, the sculptures make a wonderful addition to the islands and are in keeping with the local character and sense of place.

Ferries run regularly between Weinam Creek marina at Redland Bay and the four islands. For more information



about SMBI Art Trail and other delights of the Redlands Coast, head to [visitredlandscoast.com.au](http://visitredlandscoast.com.au)

## Along the way...

While you can take direct routes to Redlands Coast, there are also scenic routes from Brisbane and the Gold Coast that feature on the art trails. Enter the Redlands Coast via Capalaba or take a scenic detour to Wellington Point (Cullen Cullen) and you'll spot many more artistic creations.

Another option is to take a day trip to Coochiemudlo Island (Goochie mudlo) by ferry from Victoria Point (Warrer Warrer). Art is everywhere on Coochie, including the new welcome sign created by Delvene Cockatoo-Collins that includes language developed under the guidance of the Minjerribah Moorgumpin Elders. Coochiemudlo's peaceful atmosphere and stunning views have inspired many artists, as seen at the regular Coochie Markets.

**A full list of Redlands Coast arts and culture organisations can be found on the Redland Art Gallery website at [artgallery.redland.qld.gov.au](http://artgallery.redland.qld.gov.au)**







# Reconnect with nature and embrace sustainable choices

After a month of welcoming the community back to the new IndigiScapes Centre, it was disappointing when the doors were closed again due to the COVID-19 restrictions.

It was eerily quiet at the centre after the initial busy month however the phones were running hot as many residents spent their extra time at home enhancing the green spaces on their property. The Environmental Partnerships team alone provided more than 5248 native plants to their participants between the months of March to June.

With the easing of restrictions, IndigiScapes has reopened to the public with a few minor changes. Under the centre's COVID-19 management plan there is increased cleaning, social distancing procedures and bookings are now required to secure a table at the IndigiCafe. This hasn't interrupted the steady flow of visitors returning to the new centre.

Lee and Lois Collinge, who bought their property close to IndigiScapes after visiting one of their past IndigiDay Out events, were thrilled to visit the centre with their grandchildren.

"We just bought more plants from the native nursery and it's been lovely watching the grandkids interact alongside other children in the natural playspace again," Lois said.

IndigiScapes has seen many familiar faces return but they have also noticed a jump in new visitors, like Melissa, her mother Helen and son Kai.

"My mother has never been to IndigiScapes before and Kia and I haven't been here in years," she said. "I was thrilled to see how much has changed. There is so much more to see and do. The discovery centre has been a real hit with Kai and he's learning a lot about the local native plants and wildlife."

IndigiScapes is Redland City Council's environmental education Centre situated on 14.5 hectares of serene natural bushland on Redlands Coast. It offers native botanical gardens, a native nursery, bush trails, a nature playground and café specialising in local cuisine with a bush tucker twist.

The IndigiScapes team are here to help you reconnect with nature in their beautiful grounds, learn how to support the natural environment on your property and find practical solutions to help you make sustainable choices every day.

IndigiScapes would like to welcome you back. So, if you haven't had the opportunity to visit the centre since its reopening, be sure to drop in with friends or family and enjoy what the new centre has on offer.

Check the website for opening hours and be sure to book a table at the Café to try their famous IndigiCafe.



CONNECTING: Lee and Lois Collinge with grandchildren Quinn and Kia.



# 6 things

## every Redlander should do

*(and now's a good time!)*



### Taste of our bush

How's crispy bush-spiced chicken washed down with lemon myrtle tea sound?

Or maybe a slice of IndigiCake or Ketjera damper?

There's a real bush tucker twist to the menu at the award-winning IndigiCafe at Council's IndigiScapes Environmental Centre, where the aroma of myrtle, lillypilly, wild lemongrass and bush spices abound.

Set within 14.5 hectares of natural bushland, you can even take a guided bush tucker tour or visit the gift shop and take some of the flavor home with you.

The IndigiCafe is open from 10am to 3pm seven days and bookings are essential. With your safety in mind, there are three session times:

- Morning tea, 10am–11.30am
- Lunch, 12 noon–1.30pm
- Afternoon tea - 2pm–3pm

Find out more and see the new menu at [indigiscapes.redland.qld.gov.au](http://indigiscapes.redland.qld.gov.au).

**1. Immerse in a Quandamooka experience.** Our area's traditional heritage and culture is rich indeed and something we should all get to know better. Go to [quandamookacoast.com.au](http://quandamookacoast.com.au) for details of guided cultural tours on North Stradbroke Island (Minjerribah). You can also book a Goompi Trail experience with a Quandamooka guide from Stradbroke Ferries which explores Dunwich and covers aspects of Aboriginal life such as the fish ring, bush medicines, local food and how artefacts are made. Complete the experience with a visit to Salt Water Murris' Quandamooka Aboriginal Art Gallery (9am-2pm, Tuesday-Friday, 8.30am-12.30pm weekends) and the Island Arts Gallery (open every day 9am-2pm). Talk to the helpful crew at the Redlands Coast Visitor Information Centre on 1300 667 386 about the options available.

**2. Go land-based whale watching.** While you are on Straddie, head to picturesque North Gorge Walk and see who can spot the first whale (or a heap of other marine creatures). It is rated one of the best land-based whale-watching spots on the east coast. If you get the taste for it, you can also get fresh seafood straight from the trawler at Amity Point. Travel to and around the island costs about \$30 for an adult (water taxi return ticket + bus pass) and \$16 for a child (water taxi return ticket + bus pass). Alternatively, Stradbroke Ferries are running specials on selected dates that allow you to take a car over at a discounted rate, so check their website.

**3. Get to Coochie.** Taking the short water taxi ride over to Coochiemudlo Island (Goochie Mudlo) from Victoria Point really is one of the best little escapes around yet many Redlanders never get there. The sheltered beach is a little piece of paradise with plenty of barbecue and picnic spots. Or you can hire a pontoon barbecue boat or head off on the island's awesome coastal walking trails. There are two cafes near the jetty (one even has its own art gallery) where you can buy light meals and refreshments. Adults can travel on the water taxi for \$10 return and children only \$5 return.

**4. Hit the tracks.** Warm up with a hike to Mount Cotton summit for views out to Moreton and Stradbroke Islands (it's particularly beautiful at sunrise or sunset). You can begin at 640 West Mount Cotton Road near the roundabout (opposite the quarry entrance and lookout for the signed entry). If that isn't enough, why not walk or cycle Eddie Santagiuliana Way from Cleveland to Thornlands (wheelchair and pram friendly) or take in the wild surrounds of Redlands Track Park, Bay View Conservation Park, Venman's National Park, Don and Christine Burnett Conservation Area or the Southern Moreton Bay islands.

**5. Connect with nature.** If the story opposite isn't a big enough hint, you really can't call yourself a Redlander unless you can wax lyrical about everything that Capalaba's IndigiScapes has to offer. It is an awesome place for kids, go for a wander to learn about our naturally wonderful environment, have a bush tucker experience at the cafe or simply meet up with friends. You'll find all the details at [indigiscapes.redland.qld.gov.au](http://indigiscapes.redland.qld.gov.au)

**6. Go island hopping.** Catch the water taxi and make your way around the Southern Moreton Bay Islands. Karragarra Island is the first stop, just 15 minutes from the Weinam Creek ferry terminal at Redland Bay, and a great spot for a picnic on the foreshore and maybe a visit to the community gardens. Next is Macleay Island where a meal at the bowls club with its stunning views and the Macleay Island Arts Complex (10am-3pm, Tuesday-Sunday; art classes available). It is then on to Lamb Island where you can walk the heritage trail, then another seven-minute ferry ride to Russell Island where there are plenty of top-notch cafes and you can enjoy views over Canaipa Passage out to North Stradbroke Island. On the water taxi, inter-island travel is free so you can do the whole trip for \$16 return for an adult paper ticket and \$8 return for children (even cheaper if you use your gocard). The SMBI Little Bus is available on Macleay, Lamb and Russell Islands so visitors can get around the island with ease. They also provide tours of Macleay Island.

[visitredlandsc coast.com.au](http://visitredlandsc coast.com.au)





# Getting Redlands Coast moving again

Jobs, essential infrastructure and community services are at the heart Redland City Council's \$327 million COVID-affected budget for 2020-21.

Redland City Council is making a massive capital injection into the city aimed at generating and preserving local jobs and adding to and sustaining vital community infrastructure and services.

More than half of Council's projected record capital spend this financial year will go towards transport and traffic solutions, with a dozen big-ticket projects and programs alone costing more than \$30 million.

Mayor Karen Williams said Council would also continue to work with the state and federal governments to bring forward further funding for a multi-million-dollar catalogue of other shovel-ready road and transport infrastructure projects to bolster its \$327 million budget for 2020-21.

"Right now we need money spent in our city and, with Council being one of Redland Coast's largest employers, we

are taking up the challenge by ensuring local money creates local jobs," Cr Williams said. "Council has been diligent in maintaining low levels of debt and a strong balance sheet over the years in preparation for a rainy day and the rain has arrived, so with local businesses struggling we are going to spend local to keep locals employed."

There is a strong focus on active transport options, with more than \$5.8 million directed at footpaths and cycleways alone to make it easier for the community to leave the car at home and get on their bikes or head out for walks.

The \$80 million in budgeted capital expenditure is expected to hit a record of more than \$90 million once carry-over funds and anticipated state and federal assistance is factored in.

"More than \$9 million will be injected into the city's Road Renewal Program,

with \$1.8 million going to Regional Road Alliance Program projects and another \$1.7 million to the Roads to Recovery Program," Cr Williams said.

"Another \$1.5 million will go towards our bus shelter and seat renewal program and \$525,000 for the Cleveland Rail bus station. We want to encourage more residents to use public transport than just have machines laying bitumen.

"Our island communities will benefit from the start of a \$28.6 million two-year project to upgrade the jetties, gangways and pontoons at Russell, Macleay, Lamb and Karragarra islands, with \$3.5 million for the Russell island project.

"At Weinam Creek, the gateway to the Southern Moreton Bay Islands, we have dedicated \$3.4 million for the carpark development, and we have committed another \$1.5 million to the sealing of island roads."



# A BUDGET FOR THE TIMES

What's in Redland City Council's record **\$327 million** budget for 2020-21



## Capital works program

**\$80 million**

aimed at generating and preserving local jobs.



## Pensioner rebates

**\$3 million**

Including \$335 for full pensioners and \$167.50 for part-pensioners, plus another \$467,000 in other utility charge rebates.



## Average general rates increase

**62¢ a week**

For an average owner-occupier in rating category 1a (excluding State Government water and waste charges), with the:



Environment separate charge

↓ **4.7%**



Landfill remediate charge

↓ **almost 26%**



## Island projects

**\$11.1 million**

as part of a total allocation of \$21.6 million to care for Redlands Coast island communities.



## Parks and sportsgrounds

**\$13.8 million**

including playgrounds, recreation parks, tracks and trails and sporting facilities.



## Transport, paths and roads

**\$30 million**

including active transport initiatives, footpaths, cycleways, road renewal, traffic infrastructure and major projects.



## COVID-19 safety net

**\$3 million**

including \$1 million in 2020-21 to directly support Redlanders, businesses and community groups.



## Community services and facilities

**\$2 million**

including libraries, galleries, the Donald Simpson Centre and Redlands Performing Arts Centre. That's on top of the \$17 million need to operate them.



## Marine and foreshore

**\$10.2 million**

For marine and foreshore projects, including canal and breakwater works.



## Water, waste and wastewater

**\$12.7 million**

including significant system upgrades, adding to the combined \$123.5 million operational budgets.

## MAJOR ROAD, TRAFFIC AND TRANSPORT PROJECTS AND PROGRAMS

### Road Renewal Program

**\$9 million**

### Russell Island pontoon upgrade

**\$3.5 million**

### Raby Bay revetment walls and groynes

**\$3.7 million**

### Weinam Creek development carpark

**\$3.4 million**

### Wellington Street and Panorama Drive road upgrade

**\$3.3 million**

### Southern Redland Bay boat ramp

**\$1.8 million**

### Regional Road Alliance Program

**\$1.8 million**

### Roads to Recovery Program

**\$1.7 million**

### Southern Moreton Bay Green Seal program

**\$1.5 million**

### Bus shelter and seat renewal program

**\$1.5 million**

### Canaipa Point Drive off-road footpath (Oasis Drive – Keats Street) Russell Island

**\$795,000**

### Kinross Road upgrade, Thornlands

**\$700,000**

### Main Road, Wellington Point, footpath and retaining wall upgrade

**\$650,000**

### Cleveland Rail bus station

**\$525,000**

### Moreton Bay Cycleway, Victoria Point

(School Road – Pt O'Halloran Road) **\$500,000**



## REDLAND CITY BUDGET 20-21

# Investing in places to play & relax

Redland City Council will spend more than \$31 million enhancing and maintaining the city's naturally wonderful open spaces and creating an exciting new sport and recreation precinct.



*IN PLAY: An artist's impression of the proposed Redlands Coast Regional Sport and Recreation Precinct at Mt Cotton.*

The budget investment for 2020-21 builds on a multi-million-dollar program of park and playground upgrades across the city in recent years and follows the acquisition of key strategic land for community use, including the former Commonwealth land at Birkdale, historic Willard's Farm, the Redlands Coast Regional Sport and Recreation Precinct at Mt Cotton and the former Department of Primary Industries land at Alexandra Hills.

It includes \$612,000 to progress the Redlands Coast Regional Sport and Recreation Precinct proposal for Heinemann Road, Mt Cotton. The masterplan for the new multi-million-dollar regional sport and recreation precinct has been approved, with the

project implemented in stages to provide exciting new sporting facilities.

In a further commitment to supporting sports groups, major renewal projects are also planned for Thorneside's William Taylor Memorial Sportsfield and Redland Bay's Charlie Buckler Sportsfield.

All up, the budget includes \$13.8 million for improving popular community parks and sports fields.

There is \$1.6 million for the Hanover Drive Park upgrade at Alexandra Hills, \$1.3 million for Apex Park at Wellington Point, \$1.1 million for Headland Park at Point Lookout and close to another \$1 million for the next stage of Thornlands Community Park.

Substantial works have also been either completed or are under way in Raby Esplanade Park and at North Stradbroke Island's Point Lookout Oval.

Simply maintaining Redlands Coast's parks – mowing and cleaning to keep them in tip top shape and safe – will take the total investment to \$30.2 million in 2020-21, while fire mitigation alone costs almost \$2 million.

With sports groups particularly hard hit by measures to keep COVID-19 at bay, Council is also continuing to work with those clubs suffering financial hardship to ensure they can continue their services to the community.





## Green bins do more for less

Council is making it easier for mainland residents to help keep a lid on the amount of green waste that ends up in landfill by waiving the establishment fee for household green waste bins. Besides saving you money, it will also save you time taking green waste to our recycling and waste centres. These lime green-lidded bins are collected every two weeks on the mainland, further helping residents protect their property from potential storm damage through regular garden clean ups. Council audits show almost a third of our general waste wheelie bin is green waste, which ends up in landfill; so the more households that have a green waste bin, the more that can be recycled into mulch and other landscaping products. It costs \$1.23 a week to opt-in for the green waste service. For more information or to order a green waste bin, visit [redland.qld.gov.au/greenwaste](http://redland.qld.gov.au/greenwaste) or contact Council's Customer Service Centre on 3829 8999.

## What's a quick and easy way to help save our environment?

### PAPERLESS BILLING!

Register now to have your rate notice delivered by email.

Simply register for myServices through Council's website:

- Visit [redland.qld.gov.au/myServices](http://redland.qld.gov.au/myServices) where you can log into or register for myServices.
- Once logged in to myServices, go to the 'myProperties' page and select 'Send Rate Notice by email for this property'.

Make sure you add Redland City Council to your email contact list to avoid your rate notice going to your junk or spam mailbox.

Look out for the QR image on the front of your rate notice. An even faster way to pay your rates!

Easy as 1, 2 & 3!

- 1 Hover your mobile device camera over the QR image on your rate notice to scan it and it will take you directly to Council's secure website.
- 2 Enter the amount you want to pay.
- 3 Enter your name, email address and select 'Pay Now'.



Biller Code:  
Ref:

Telephone & Internet Banking – Br  
Contact your bank or financial institution to make t  
payment from your cheque, savings, debit, credit c  
or transaction account. More info: [www.bpay.com.au](http://www.bpay.com.au).

### Payment Online



[www.redland.qld.gov.au](http://www.redland.qld.gov.au)  
Use your credit card to pay 2  
hours 7 days per week.  
Reference No: 207611

### Payment By Phone



1300 300 943

Visa, Mastercard. 24 hours.  
7 days per week.

Reference No: 207611

## City takes a hit but ensures quality water supply

Despite years of advocacy by Redland City Council, residents have again been hit with a hefty bulk water increase by the State Government which will add about another \$36 to the average residential annual rates bill.

It follows years of significant bulk water price increases charged by the State Government (below).

The delivery of water to Redlands Coast households and businesses – a food-grade product direct to your kitchen – will cost more than \$12.2 million in 2020-21, while the cost of maintaining, upgrading and extending the city's sewerage network will top \$54.6 million.

### State bulk water increases Council retail water increases

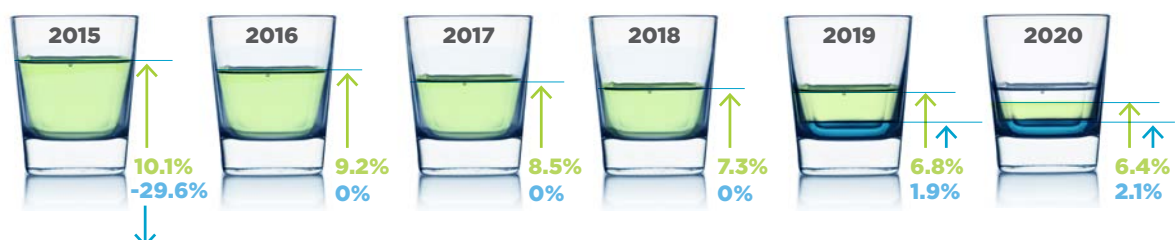



# Island connections

**Over the next three years, Russell, Macleay, Lamb and Karragarra islands will get new and improved ferry terminals – including jetties, gangways and pontoons – in one of Redlands Coast’s largest-ever marine infrastructure projects.**

The \$34 million undertaking, which has been in the planning by Redland City Council and the Department of Transport and Main Roads since 2014, will have significant transport, tourism and recreational benefits for the region.

Redland City Mayor Karen Williams said the Southern Moreton Bay Islands Ferry Terminals Project would be delivered about 12 months sooner than originally expected, offering local jobs and saving residents money.

“This is an exciting partnership between Council and Transport and Main Roads that will see four new ferry terminals delivered for our Southern Moreton Bay Islands, helping residents and visitors move around our beautiful Redlands Coast faster and safer,” Cr Williams said.

“Through this partnership, Council and Transport and Main Roads have found a way to deliver the project sooner and in doing so save ratepayers \$2 million,

with a total saving of \$5 million across the entire project, including State Government savings.

“This exciting development will also see more jobs created this financial year, which is vital following the economic impacts of COVID-19.”

Council has also confirmed that, as part of the project, new toilet facilities would be built at the upgraded ferry terminals at Russell and Macleay islands.

Cr Williams said the project would help the region bounce back from COVID-19, with tenders for construction expected to go out by the end of August, cutting about a year off the time it will take to get the work done.

The project will ensure the new ferry terminals are compliant with the Disability Standards for Accessible Public Transport and repurpose the existing terminals for recreational uses such as fishing and mooring.



*INVESTMENT: Preliminary design for the Russell Island terminal. Final detail design is close to completion.*



The important upgrades are not just a daily necessity for island residents but are vital to Redlands Coast's economic future and support the islands' increasing population and number of visitors.

"The islands are already recording more than a million ferry trips a year.

Informed through extensive consultation with island communities, Quandamooka Yoolooburrabee Aboriginal Corporation, and other key stakeholders, the new, fully accessible ferry terminals will provide:

- Improved screening and more waiting areas to better protect passengers from the weather;
- Larger, accessible pontoons with more seating areas;
- Wider jetties and gangways;
- Drinking fountains;
- Improved security with lighting and 24-hour video recording;
- Improvements to the landside waiting areas, including seating and bike racks; and
- Increased ferry capacity and new toilet facilities at Russell and Macleay Islands.

The preliminary designs were presented to island communities in November 2019 at a series of open houses on each of the four islands and on the mainland and received very positive feedback.

The Russell Island ferry terminal will be the first to undergo construction due to its deteriorating condition, with works planned to begin this financial year.

The project's detailed design phase is nearing completion, with 3D versions of these technical designs planned to be showcased on the project's page at [redland.qld.gov.au/FerryTerminals](http://redland.qld.gov.au/FerryTerminals)

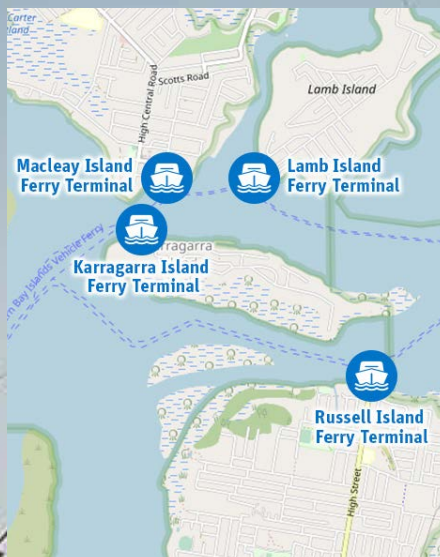

## About the project

- The Southern Moreton Bay Islands project will replace ageing ferry terminal infrastructure and re-purpose existing infrastructure for recreational boating.
- The terminals will be replaced progressively over the next three years, starting with Russell Island.
- Passenger safety will be improved through wider jetties and gangways, safe and accessible covered waiting areas and weather protection.
- The efficiency of ferry services will be improved to address overcrowding and support the area's future growth.
- The project will align the operation, ownership and maintenance responsibilities for the terminals and associated infrastructure with Queensland's statewide approach.



## Galleries and libraries get a huge boost

Support for Redlands Coast's much-loved community treasures totals more than \$20 million in the city's 2020-21 budget as they reopen their doors after closures forced by COVID-19 restrictions.

Mayor Karen Williams said the funding to operate and enhance local libraries, art galleries, the Redland Performing Arts Centre (RPAC), IndigiScapes Environmental Centre and support for the Donald Simpson Centre was a worthy investment in community wellbeing.

"These are among our most popular community spaces and synonymous with Redlands Coast's lifestyle, playing such an important role in satisfying our appetite for enrichment, both cultural and educational," Cr Williams said.

"With further relaxation of the State Government's COVID-19 restrictions, we are ensuring they can swiftly return to full services and continue to support our residents' wellbeing as well as playing an important part in our economy through attracting patrons for local restaurants, cafes, pubs and clubs."

More than \$13.3 million will go to run and invest in libraries, \$3.5 million for RPAC and \$884,000 for galleries.

The library resource renewal program alone will absorb \$1 million, while another \$1.2 million will go to operate IndigiScapes and its environmental programs.

This follows the \$3 million transformation of the centre completed earlier this year which many residents are yet to experience due to the impact of COVID-19.



# EXCITING MILESTONE FOR NEW-LOOK CAPALABA CENTRE

A masterplan for the rejuvenation of Capalaba's shopping and business hub is now being developed.

Following an extensive expression of interest campaign by Council and Redland Investment Corporation, Council has announced Shayher Group as its preferred development partner and has entered into a Memorandum of Understanding, setting out a plan for the next phase of negotiations.

Division 8 Councillor Tracey Huges said the next step of the process was for a masterplan to be developed that matched the Council planning scheme and for commercial agreements to be negotiated.

"This is an exciting milestone in the transformation of Capalaba's central precinct into a place our community can be really proud of; somewhere that is vibrant, inviting and great for families," Cr Huges said.

## **Cr Tracey Huges**

Division 8: Birkdale South, Alexandra Hills, Capalaba and Wellington Point

Ph: 3829 8600 M: 0427 734 214  
E: [tracey.huges@redland.qld.gov.au](mailto:tracey.huges@redland.qld.gov.au)



**DIVISION 8**

Our  
REDLANDS  
coast



*EXCITING: The preferred development partner for the revitalised Capalaba town centre and transport hub has been appointed.*

"Council's vision is for the Capalaba hub to be reactivated as a people place which is easy and safe to get around, with an after-hours' economy and which is an enjoyable place for residents to shop, dine and relax."

The vision for the project includes the reinstatement of current civic assets, including the Capalaba library and arts centre, Council's customer service centre and community hall.

"We want the design to be innovative and economically sustainable," Cr Huges said.



The project also aims to become a catalyst for much-needed transport infrastructure at the northern gateway to Redlands Coast.

## **Let's help our posties**

Residents are being urged to ensure they keep their neighbours and the local postie safe by ensuring dogs are properly enclosed on their properties.

Redland City Council is working with the Australia Post team at Capalaba Delivery Centre, pictured below, to raise awareness of the safety hazard that posties face.

Division 8 Councillor Tracey Huges said responsible pet ownership extended to ensuring dogs did not stray from yards or cause distress to others.

"Being lunged at by an aggressive dog can be a nasty shock for the postie while delivering your letters or parcels and scary for people simply walking by," Cr Huges said. "It has been an issue for a while, with quite a few reports from concerned posties, so I urge dog owners to do the

right thing and ensure their pets aren't creating a potential safety hazard."

In 2019, Capalaba Delivery Centre identified 149 properties with dogs which were aggressive towards posties, with nine attacks reported. Council will investigate complaints of dog enclosures not being effective and inspect properties concerned.

"Our animal management officers work with residents where issues are identified and recommend ways to reduce the risk of an incident," Cr Huges said. "I ask dog owners to ensure their letterbox can be safely accessed by their postie. If you are expecting a parcel delivery, please ensure your dog is responsibly restrained so your front door can be approached safely."

Reports can be made at [rcc@redland.qld.gov.au](mailto:rcc@redland.qld.gov.au) or by calling Council on 3828 8999.





# KEEPING A CARING EYE ON OUR KOALAS

The health of Redlands Coast koalas will soon be in sharper focus thanks to a Council grant for wildlife monitoring cameras.

The two cameras will be used by the local Koala Action Group to capture photographs and videos of koalas to assess their health and for use in community education campaigns.

Division 9 Councillor Adelia Berridge said she was thrilled that funding was made available through the Mayor and Councillors Community Benefit Fund for a project of such ecological importance.

“Our koalas are cherished residents of Redlands Coast and whatever can be done to keep them healthy and safe is vital,” Cr Berridge said.

“With the help of these cameras temporarily installed at properties where koalas are known to frequent, volunteers will be able to monitor their health and movement. This non-invasive method of monitoring will capture pictures and videos of koalas which can be uploaded and used to assess their health and also to educate the community on ways they

can do their own monitoring of koalas by showing images of what to look for.”

A Koala Action Group spokesperson said the cameras would be particularly invaluable during koala breeding season when they became much more active.

“The cameras will be a useful tool to assist with the monitoring of koalas, identifying individuals and hopefully earlier detection of disease,” the spokesperson said. “The two different cameras – one with a standard lens and the other a wide-angle lens - will be able to capture a variety of images and videos as koalas move between trees and enable early detection of disease if it is present.”

Cr Berridge said Capalaba residents could also help by reporting koala sightings online at [biocollect.ala.org.au](http://biocollect.ala.org.au) or calling the Koala Action Group on 3823 5575.

Cr Berridge said she was also pleased to support a Council grant to Big Red Mental Health for its new gardening group. The money was used to create four new garden beds at the group’s outdoor area on Mt Cotton Road, which was also supported by Council.

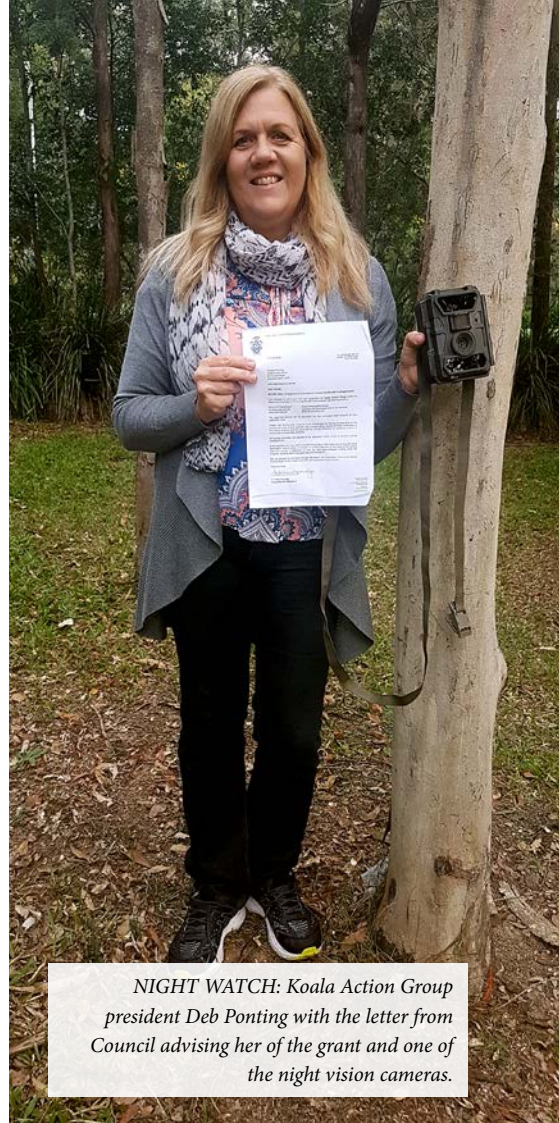

*NIGHT WATCH: Koala Action Group president Deb Ponting with the letter from Council advising her of the grant and one of the night vision cameras.*

## Youngsters on the move

The chances are you will spot a young koala on the move through Redlands Coast at this time of year. And while we all need to be extra vigilant as they move into busy areas, Redland City Council’s wildlife team say it is quite normal to see small, young koalas by themselves.

“Our kids often look way too young when they leave home and it is the same for koalas,” a team member said.

“At this time of year, our Wildlife Rescue Service gets a huge increase in calls from people concerned about koalas in built up

areas. These are young koalas, so they are small, and people often mistakenly think they have lost their mum or are somehow lost or confused.

“In reality, this is normal behaviour. It’s time for them to leave their mums, head out and search for their own territory, so they wander around a lot. But they are fine and doing what comes naturally. They are often curious and sometimes take a rest stop in some unusual places.”

The team advises to keep an eye on them if they appear to be heading into danger, such as crossing a road or railway tracks, and to call the Wildlife Rescue Service if they are visibly sick, hurt or at risk of injury.

“Otherwise to let them be and don’t try and herd them in a direction or move them unless they are in immediate danger,” the team member said.

You can find out more about koalas and Redland City Council’s Wildlife Rescue Service by visiting [redland.qld.gov.au/Koala](http://redland.qld.gov.au/Koala)

## Wild encounters

To report sick or injured wildlife, call Redlands 24-hour Wildlife Rescue on 3833 4031.



**Cr Adelia Berridge**  
Division 9: Sheldon, Capalaba and Thornlands

Ph: 3829 8620 M: 0435 538 278  
E: [adelia.berridge@redland.qld.gov.au](mailto:adelia.berridge@redland.qld.gov.au)



**DIVISION 9**



# CREATING AN EXCITING PLACE FOR COMMUNITY



EXCITING: Possibilities for Beth Boyd Park.

Redland City Council is seeking community input on a range of upgrades to Thorneside's Queens Esplanade Park to identify shared community values.

Division 10 Councillor Paul Bishop said the input would help guide changes to the broader Thorneside Foreshore Precinct in keeping with the significance of the place.

He said Beth Boyd Park was one of the most beloved open spaces in Redlands Coast's northwest.

"It's an area with naturally wonderful features such as birdlife and scenic vistas, where all kinds of active and passive

recreation take place within a relaxed seaside neighbourhood," Cr Bishop said.

"This consultation provides a great opportunity to recognise that the park is a key element of the broader Thorneside Foreshore Precinct and Waterloo Bay, which is one of Redland Coast's genuine naturally wonderful recreational gems.

"In addition to hearing what people value about the area now, we really want to know what residents wish to see prioritised, such as parking, pathways, lighting, shade, public art, seating and even ideas in preferred play experiences for children in the upgraded playground. In essence, we want users and neighbours to help co-design a place that really epitomises what Redlands Coast is all about.

"We already have various ideas from the surveys Council has run and we are continuing to listen to nearby residents and engage with our community so feedback can inform future upgrades. While changes will be subject to budget prioritisation and Council approval, it is important to know that they will be part of the ongoing management of the entire Thorneside Foreshore Precinct. I am keen to ensure council reflects the strong community, cultural and environmental values of this place."

Cr Bishop said it was hoped some of the park's existing features could be preserved.

"We know the pedal coaster is well loved so we will look at retaining that, subject to an assessment of its condition. It is also proposed that the hill slide be replaced with two new covered slides," he said.

"Sadly, officers have informed me that the timber boat is no longer compliant

and simply isn't in good enough shape to retain. This is the community's opportunity to provide feedback on what should be in this space to improve the foreshore experience and allow better access to the coastline, which I trust will recognise its unique placement and importance to many locals. We already have budget for the planning and concept designs and, with an understanding of what the community wants, Council intends to allocate an appropriate budget to complete the works."

You can have your say by calling Council on 3829 8999, emailing the project team on [civicanopenspace@redland.qld.gov.au](mailto:civicanopenspace@redland.qld.gov.au) or visiting [yoursay.redland.qld.gov.au](http://yoursay.redland.qld.gov.au)

## Birkdale land update

Consultation on the future of the former Commonwealth land acquired by Council at Birkdale is on track for late this year.

Councillor Paul Bishop said that with part of the site associated with the former US Army Radio Receiving Station entered into the state heritage register, Council was now pushing ahead with its planning for the historic property on 362-388 Old Cleveland Road East.

"Now that the extent of state heritage is known, Council is finalising various management plans and studies for this significant area," Cr Bishop said. "This will inform the next stage of the planning process which will include the public consultation, likely later this year, on how the land may be activated and used."

August marks 75 years since the Birkdale station first received historic news of the Japanese surrender, marking the end of World War II.

## Cr Paul Bishop

Division 10: Birkdale and Thorneside

Ph: 3829 8605 M: 0478 836 286

E: [paul.bishop@redland.qld.gov.au](mailto:paul.bishop@redland.qld.gov.au)



**DIVISION 10**





*SPIRIT: Local businesses such as Salads Made Fresh and Social Chat Coffee have been helping each other through COVID-19 while, right, Scott Jacka and his family enjoy the new equipment in Raby Esplanade Park.*



## NEW PLAY SPACES, COUNCIL SUPPORT COMMUNITY WELLBEING

Redland City Council programs and projects, including improved play spaces, have been be a “lifesaver” during COVID-19 restrictions, according to Division 1 Councillor Wendy Boglary.

Cr Boglary said she was particularly grateful that new fun playgrounds at Ormiston’s Raby Esplanade Park and Wellington Point’s Apex in Starkey Street were opened in time for the last school holidays.

“In these uncertain times, all aspects of our community are valued even more highly and we are grateful again for all we have in Redlands Coast,” she said.

“After coping with COVID-19 restrictions, which also affected travel, I was thrilled that local families had two great new adventure playgrounds to enjoy and explore.

“Redlands Coast’s outdoor environmental areas, including our parks, bike tracks, pathways and simple open spaces, have been a lifesaver for many residents, allowing safe physical exercise and a breather for our mental health.”

Cr Boglary said she was also continuing to work with Council for greater protection of Redlands Coast’s environmental areas, “which are our greatest liveability and economic assets”.

She also urged residents affected by the current uncertain times to “please reach out for a chat” if they felt the need.

“Council has been working closely with many organisations and they are here to support you,” she said.

“Within our local economy, our businesses have also been so supportive. Although many have been unsure of their own futures, they have been donating meals to frontline workers, the homeless, making masks for medical personal, delivering meals ... there have been many examples of their commitment to our Redlands community.

“In return, I ask that we show our gratitude and support for our local businesses wherever possible. Recently Council placed a greater weighting in the tendering process for local businesses but we can all take positive actions by perhaps buying early Christmas presents or getting an extra take-away per week.

“I have been talking to businesses and connecting those that can possibly assist each other such as Luis from Social Chat Coffee at Ormiston to Salads Made Fresh, owned by locals from Wellington Point. Let’s promote our local businesses by supporting ‘buy local’ for our economy and also local employment.

“So far, Council has awarded more than 600 contracts to local suppliers worth about \$22 million. It has also provided grants to 16 community groups and 81 businesses as part of its \$3 million social and economic package to support our community through these times.

“In Redlands Coast we have always been fortunate and had many reasons to be grateful - our community is our strength. Let’s keep building our spirit ... support local, champion each other and, please, if you need a hand in any way reach out and use the number provided here.”

Supported by Council, a Disaster Chaplaincy Hotline has been established to help those affected by COVID-19. It operates daily from 8am-8pm on: 1800 841 106

**Cr Wendy Boglary**

*Division 1: Wellington Point and Ormiston*

Ph: 3829 8619 M: 0408 543 583  
E: [wendy.boglary@redland.qld.gov.au](mailto:wendy.boglary@redland.qld.gov.au)



**DIVISION 1**



# AQUATIC CENTRE REVIVAL

Cleveland Aquatic Centre is undergoing a revitalisation with plans to re-open in time for the busy summer season.

The pool is closed until October for essential maintenance under plans agreed by Redland City Council and centre operator Belgravia Leisure and supported by a \$830,000 State Government Works for Queensland grant.

Division 2 Council Peter Mitchell said Council had used the mandated COVID-19 closure of the aquatic centre in March as an opportunity for a more detailed centre upgrade.

"Work had already started to trace and repair a suspected leak in the 50-metre pool as COVID-19 restrictions first began," Cr Mitchell said.

"With the additional support of the Works for Queensland funding, we are going full steam ahead with a range of much-needed maintenance and repair activities in order to reopen the centre in October. This includes repairing pipes and tiles, as well as lighting and electrical upgrades, along

**Cr Peter Mitchell**  
Division 2: Cleveland and  
North Stradbroke Island

Ph: 3829 8607  
E: [peter.mitchell@redland.qld.gov.au](mailto:peter.mitchell@redland.qld.gov.au)



**DIVISION 2**



*IN THE SWIM: Cleveland Aquatic Centre is being revitalised ahead of a planned October re-opening.*

with work to make it more attractive to users, including replacement of the shade sails."

Cr Mitchell thanked the State Government for providing funding for the centre.

"The Cleveland Aquatic Centre supports local jobs and vital community activities ranging from recreational swimming, learn-to-swim, health and occupational classes, to carnivals and events," he said. "As well as supporting a vital community

asset, this funding will go to support local jobs and local businesses."

Cr Mitchell said while the closure of the Cleveland Aquatic Centre until October was understandably frustrating for keen users, the wait was necessary and would be worthwhile.

"The disruption caused by COVID-19 has allowed us to get stuck into renovations with the least impact before the return of peak season and, hopefully, the further easing of COVID-19 restrictions," he said.

## Inspired makeover for Straddie's Headland Park

Point Lookout's Headland Park is set for \$1 million-plus upgrade which will draw inspiration from the unique Minjerribah landforms and ecosystems.

"The need for a major upgrade has grown over recent years with developing trends in children's play, enhancement of tourism opportunities and sensitivities to the local environment," Councillor for North Stradbroke Island Peter Mitchell said.

He said the renewal would include an "inventive and vibrant" new play space, right, complete with a shell cubbyhouse, in keeping with the island's stunning environment.

"It will cater for a wide range of ages and skills, with a multitude of play opportunities that not only benefit children physically but also encourages them to learn about the local environment," Cr Mitchell said.

He said work on the upgrade, which would include resealing the existing overflow car park to manage erosion, was planned for early to mid next year.

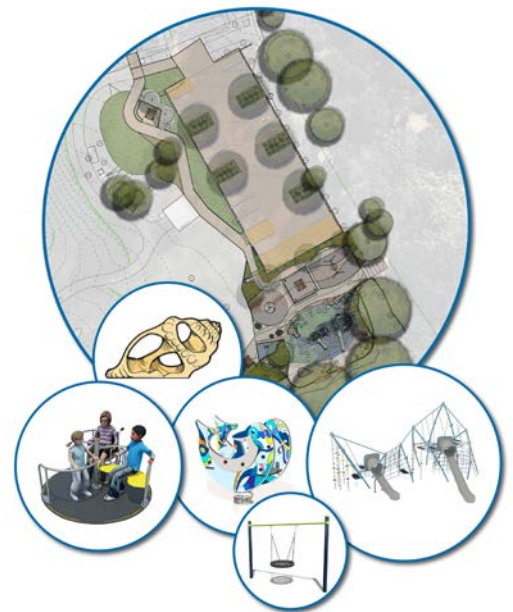

## Cleveland parking trial

Council will conduct a six-month trial of short-term parking at specific locations within Cleveland's CBD.

Cr Peter Mitchell said the trial of 60-minute and 30-minute parking bays on the eastern side of the corner of Bloomfield and Middle streets and adjacent retailers on either side of the

Westpac Bank was aimed at improving access for shoppers and followed requests from businesses.

"We will gather community feedback during the trial to see whether it helps businesses which have struggled through the pandemic to attract customers," Cr Mitchell said.





**FUN TIMES:** The latest additions to Thornlands Community Park have been proving a huge hit with local families and visitors.

# GROWING PARK AN INVESTMENT IN FUN AND FAMILIES

The latest additions to Thornlands Community Park have been proving a huge hit with local families and visitors.

What was once a bare paddock has come alive with the latest \$2.1 million addition opening in time for the recent school holidays.

According to Division 3 Councillor Paul Golle, there's more to come for what has become a local showpiece at the corner of Cleveland-Redland Bay Road and Waterline Boulevard.

"I have watched with excitement as Thornlands Community Park has emerged from what was just a grassy patch a few years ago into a wonderful community space loaded with opportunities for good, healthy, outdoor fun," Cr Golle said.

"The new all-abilities play space will feature a double flying fox, water auger and mud pit; and incorporate additional picnic settings, barbecues, shade, and seating all within a fully fenced area.

"This financial year will also see the inclusion of an extra agricultural-themed mounded play area for climbing, sliding

and tunnelling within the fenced play area and fitness equipment outside."

Cr Golle said the park was a "massive ratepayer investment" in terms of both funding and design.

"This is rates money which has been invested in our community and in consultation with residents for the benefit of all," Cr Golle said.

Cr Golle worked closely with the community through public consultation and Council staff in advocating for the budget and design of the new park.

"It's important to invest into livability locally so our kids have somewhere special and exciting to play," he said.

"The entertainment factor simply can't be calculated just in cost but in the enjoyment and wellbeing it brings to families.

"Anyone who has seen the joy on people's faces and the fun that it has provided for local kids will know just how worthwhile an investment this park is."

The next stage of Thornlands Community Park, which will cost almost \$1 million, will further expand on the play areas and

provide a new outdoor fitness area and picnic opportunities.

"A fitness zone will be installed which draws on the latest industry research and will complement the round running path within the park," Cr Golle said.

"Further planned stages include a barn-styled performance shelter, interpretative signage and other spaces to relax and be active in this new growth area."

It is part of a program of larger staged park projects across Redlands Coast designed to make them even more attractive to locals and visitors.

**Cr Paul Gollè**

*Division 3: Cleveland, Thornlands and Victoria Point*

Ph: 3829 8618

E: [paul.golle@redland.qld.gov.au](mailto:paul.golle@redland.qld.gov.au)



## Welcome to the West

Victoria Point West has been welcomed as part of Division 3 with upgrades to local infrastructure.

Councillor Paul Golle said residents around Brookfield Drive had recently benefited from footpath upgrades and streetscaping, along with improvements to the roundabout at the corner of Brookvale Drive and Bunker Road, pictured.



**DIVISION 3**





# COUNCIL ADVOCACY BRINGS MASSIVE BENEFITS

*RESULT: Cr Lance Hewlett at Victoria Point's Anita Street intersection, soon to get traffic signals as part of the duplication of a 2km stretch of Cleveland - Redland Bay Road. He is pictured with Redlands MP Kim Richards.*

**Cr Lance Hewlett**  
Division 4: Victoria Point and  
Coochiemudlo Island

Ph: 3829 8603 M: 0421 880 371  
E: [lance.hewlett@redland.qld.gov.au](mailto:lance.hewlett@redland.qld.gov.au)



**DIVISION 4**

The duplication of a 2km stretch of Cleveland-Redland Bay Road is under way to improve the daily commute through Victoria Point, and safety for road users and pedestrians.

Division 4 Councillor Lance Hewlett said Council advocacy on behalf of the local community had been critical in securing the State Government's investment in widening the busy section of the main link between Cleveland and the southern Redlands Coast.

Work on the second stage of the \$60 million State Government project, already under way, is part of a package of significant infrastructure projects for Redlands Coast, with Council continuing to advocate for much-needed improvements to state-controlled roads.

"This is something Council and I have been working on for some time as a means to significantly reduce traffic issues in this area," Cr Hewlett said.

"It will have massive benefits for southern Redlands Coast residents through improving safety and traffic flow for commuters, both in cars and on public transport.

"I'm also thrilled that we will get the traffic signals at the Anita Street intersection ... another pressing need that we have been seeking for years.

"Council has long advocated for a multi-functional corridor which safely and efficiently caters for all road users, including motorists, public transport, cyclists and pedestrians. This will deliver that."

The project includes the duplication – or four-laning - of Cleveland-Redland Bay Road from Anita Street heading north, including the intersection upgrade at Anita Street, with the State Government expecting it to create about 100 jobs.

Work is under way upgrading the stretch between the Boundary Road roundabout and Magnolia Parade, along with preparations for the duplication.

The Anita Street intersection upgrade will also include a pedestrian crossing, upgraded footpath and better provisions for cyclists, making access to the bus stop north of the intersection safer.

"Traffic control may be in place during early works, so please drive to the road conditions and follow all road signs," Cr Hewlett said.

It comes after an additional \$15 million was locked in recently by the Queensland Government as part of a \$400 million COVID-19 roads stimulus package, bringing the total investment on Cleveland-Redland Bay Road to \$60 million.



# MAJOR MILESTONE NEARS FOR WEINAM CREEK PROJECT

Construction of Stage 1 of Redland City Council's Weinam Creek Priority Development Area, which includes the new carpark on Moores Road, pathways and footbridge connecting to the ferry terminal, is nearing completion.

Division 5 Councillor Mark Edwards said the "final touches" to be made to the carpark on Moores Road would include the installation of permanent security cameras for public safety.

"We expect to have the carpark open for public use in September in what will be a substantial boost for Southern Moreton Bay Island residents and visitors," Cr Edwards said.

"The addition of the new carparking on Moores Road is an integral part of the overall masterplan and will serve as overflow parking while works on the northern side of the creek commence.

"This is something that many people connected with the islands have been waiting for and it will also help to open Redland Bay and island communities to the increase in daytrippers that is likely as people holiday closer to home."

Cr Edwards said the overall Weinam Creek masterplan would be submitted to Economic Development Queensland (EDQ) for assessment in the coming weeks, with works for improving Hamilton Street, Redland Bay, planned for next year.

"Once the overall masterplan has been lodged, it will be available for public consultation and for submissions to be made to EDQ," Cr Edwards said.

"Further communication regarding the overall masterplan and this process will become available prior to the public consultation period."



The connecting footbridge between the ferry terminal and carpark, on the north and south sides of the Weinam Creek marina, was lowered into place in May in a move Cr Edwards said would make a big difference to the lives of residents.

"This footbridge and the additional 500 car parking will help to ease the congested parking situation at the ferry terminal, as well as removing congestion in local streets," Cr Edwards said.

"Many residents have a car on the mainland as well as on the islands and this overflow parking area will be very convenient for longer-term parking, with an easy 5-10 minute walk over the footbridge to the ferry terminal.

"The Weinam Creek project will provide important community infrastructure for local families and retail options to attract visitors, as well as important community services such as medical facilities and employment opportunities."

The staged development is being delivered in partnership with Redland Investment Corporation and includes more open space; new pedestrian and cycleways; rejuvenation of existing parkland; more car parks with a multi-storey park proposed for the later stage of the development; improved drop-off and storage facilities for island residents and visitors; a new boat ramp to separate emergency and public access; and a mix of residential and retail spaces including cafes, restaurants and potential for a medical precinct.

*MILESTONE: Redland City Mayor Karen Williams and Cr Mark Edwards mark the lowering of the connecting footbridge between the Weinam Creek ferry terminal and carpark.*

**Cr Mark Edwards**  
Division 5: Redland Bay and Southern Moreton Bay Islands

Ph: 3829 8604 M: 0407 695 667  
E: [mark.edwards@redland.qld.gov.au](mailto:mark.edwards@redland.qld.gov.au)





# FIRE CREW UP AND RUNNING

Welcome to the crew who will be helping to keep the Mt Cotton, Sheldon and Redland Bay areas and their residents safe from fires.

The members of the new Brisbane Region Headquarters Rural Fire Brigade, Mount Cotton Service Group had their first official meeting in July to elect officers and the management committee.

Division 6 Councillor Julie Talty said the group was an exceptional example of a community working together to help themselves and their neighbours.

"The first group of trainees went through weekend training in July and the second group are expected to complete training at the start of September," Cr Talty said.

"The brigade currently has 18 trained volunteers and more than 50 volunteer members overall – which is an extraordinary response and underlines the sense of community in this part of Redlands Coast.

## **Cr Julie Talty**

*Deputy Mayor*

*Division 6: Mt Cotton and Redland Bay*

Ph: 3829 8606

E: [Julie.talty@redland.qld.gov.au](mailto:Julie.talty@redland.qld.gov.au)



**DIVISION 6**



READY: Volunteer members and the committee of the newly formed Brisbane Region Headquarters Rural Fire Brigade, Mount Cotton Service Group.

"From the outset we have had strong community support for the establishment of a rural fire brigade for the Mt Cotton, Sheldon and Redland Bay areas to provide the local resources necessary to assist with fire prevention and fuel-load reduction.

"With its formation we can now have greater support to proactively manage and reduce fire risk.

"I urge all residents in the region to play their role in reducing fire risk across our community to assist the brigade in its activities."



## **Movie night provides a community connection**

Residents were able to get out and enjoy an evening of movie fun at Community Connections' pop-up drive-in in the Bayview Conservation Area carpark.

Supported by Redland City Council, two *Jumanji* movies were presented on the 10m inflatable screen for the community fundraiser in July.

Local Councillor Julie Talty said that with social distancing in place and movie-goers asked to remain in their cars as much as possible it proved a fun "retro" event with more than 350 attending and cars having to be turned away.

"The Mount Cotton Scouts (pictured above right) did a roaring trade at their snacks stall and there was a great effort by volunteers such as Peter Spreadborough and grandchildren (pictured above left) who helped to make it a great evening for our community," Cr Talty said.

"I'd also like to thank Community Connections Redlands Coast for giving local not-for-profit organisations an opportunity to raise much-needed funds." Community Connections has indicated that it intends to put on another COVID-safe drive-in event soon.

## **Sportsfield carpark upgrade under way**

Work is well under way on the \$800,000 upgrade to the carpark at Charlie Buckler Sportsfield on Boundary Road at Redland Bay.

It includes resurfacing as well as the installation of stormwater pipes, kerb and channelling, street lights, footpaths and landscaping.

Local Councillor Julie Talty said the project was part of Council's \$31 million budget commitment to enhancing and maintaining the city's naturally wonderful

parks, conservation areas and sports areas this financial year.

"The upgrade will go a long way to mitigating flooding and improving safety, and will be welcomed by the clubs that use and call the sports field home," Cr Talty said.

"The upgrade is expected to be completed by the end of September, weather permitting, and is just the first of what is expected to be a multi-stage project, subject to future Council budgets."



# ALEX HILLS INSPIRES A MAGICAL MUSICAL JOURNEY

New York and London may have inspired a few songs but Redlands Coast's Alexandra Hills has inspired a whole album of music.

*Alexandra*, by musician and sound artist Andrew Tuttle, is a journey of rediscovery by the former local boy which has highlighted his old neighbourhood on the world stage.

Andrew said the album, released in May and supported by a Redland City Council Regional Arts Development Fund grant, was inspired by the place he first created and fell in love with music.

"I was doing a bit of housesitting at my parents' place and it became this opportunity to rediscover where I grew up," he recalled.

"It really made me notice the natural beauty of Alexandra Hills' parks and waterways and its urban environment.

"I drove around with a little video recorder and an audio recorder, going to places like IndigiScapes and local trails and sitting there being inspired by the natural sounds ... even sitting at the Alex Hills shops!"

Andrew said *Alexandra*, which he composed on resonator guitar and banjo and largely produced in his home studio, had since reached a huge audience well beyond the suburb's boundaries.

"It has reached a lot of people. One track, *Sun at 5 in 4161*, alone has had around 700,000 streams on Spotify," he said.

"I have international offers to perform it pending and I am also looking to perform it at a major Brisbane event in September," he said.

"The songs have a lot of space and that's something that Alex Hills has. People who haven't been to the area before will get an understanding of what this part of the world has ... plenty of space and a calmness."

Division 7 Councillor Rowanne McKenzie said she was thrilled Council was able to nurture the album's creation through its Regional Arts Development Fund grants.

"*Alexandra* is a special story about a special place. To see it take our story to so many people is wonderful," Cr McKenzie said.

"It is a great accolade for a place to have a song written about it let alone a whole album of music.

"Redlands Coast residents will instantly recognise what's behind the tracks, with Andrew's inspiration coming from local landmarks including IndigiScapes' old tallowwood tree, to Scribbly Gums and the Vienna Road intersection."



HOMEcomings: musician and sound artist Andrew Tuttle rediscovers Alexandra Hills.  
Photo: Bryan Spencer.

Andrew said his parents, Ray and Lyn, were "really proud" of the album about the place they still call home.

"Which is nice," he said. "I think they appreciate my coming home and rediscovering things taken for granted. I hope it will now inspire others to take a bit of time to sit down and listen to our beautiful nature reserves, our own backyards ... even the shops. Listen and take it in rather than taking it for granted because it is magical."

## Community park set for makeover

Alexandra Hills' Hanover Drive Park is about to get a major upgrade to make it more attractive for families throughout the area.

Division 7 Councillor Rowanne McKenzie said the popular 2.8ha space would benefit from a range of special features and play elements as part of a \$1.6 million upgrade.

"Due to changing community needs and Council's commitment to creating vibrant and active spaces, we are investing significantly in this community park to provide a quality and diverse experience," Cr McKenzie said.

"Plans include designated car parking for people with a disability, a new public toilet, improved access to the dog off-leash area, additional shelters and seating options, and great new play options for various ages and abilities, including sidewalk games on some of the paths.

"This will become a place families will be able to enjoy for longer and have a barbecue or picnic while the kids will be kept active climbing, jumping and spinning."

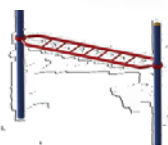

**Cr Rowanne McKenzie**  
Division 7: Capalaba, Alexandra Hills,  
Thorncroft and Cleveland

Ph: 3829 8732  
E: rowanne.mckenzie@redland.qld.gov.au



**DIVISION 7**



# Young koalas are stepping out into the world



**It's dispersal time.  
Look out for them  
and drive carefully.**

There comes a time, even for koalas, when adolescents have to leave home and find their own way in the world (plus pay for their own streaming services). It's called dispersal time. You might see young koalas crossing the road or moving through yards. Look out for them and drive carefully. Visit our web page or call us for advice.







## Sharing our naturally wonderful area with flying foxes

We all know that Redlands Coast is a great place to spend some time and relax ... something we share in common with those seasonal visitors, the grey-headed flying foxes.

Their arrival is part of the cycle in our naturally wonderful area. The Redlands Coast area provides critical winter food resources for flying foxes, especially the grey-headed variety who come here to take advantage of the winter flowering and banksia heaths on Moreton Island, North Stradbroke Island and the Southern Moreton Bay Islands.

This leads to a temporary increase in numbers in their usual roosts.

As flying foxes make a lot more noise when they are stressed or frightened, residents who live near roosts can minimise disturbance to the flying foxes, along with adverse impacts to homes, by:

- Where possible, avoiding exercising or play within the roost or Fuel Reduction Area (firebreak) until the visitors leave, usually around the end of August;
- Bringing washing in at night; and
- Parking vehicles under shelter.

While Council appreciates some residents have concerns about flying foxes, through working collaboratively, together with vegetation management, we can all aim to better share our naturally wonderful areas.

If you want to know more about living with flying foxes, contact the team at Redland City Council's IndigiScapes Environmental Centre on 3824 8611 or at [indigiscapes@redland.qld.gov.au](mailto:indigiscapes@redland.qld.gov.au)

## WHAT'S ON AT REDLAND PERFORMING ARTS CENTRE



### FAT MUSICALS: A Body of Work

All your favourite musical theatre hits in one hilarious show! Join us for a satirical look at musical theatre and its greatest (thinnest) leading ladies.

**FRI 4 SEP 7.30PM • TICKETS: \$32-\$35**



### WILBUR THE OPTICAL WHALE

Go on an adventure with Wilbur, the friendliest giant in the sea. The whole family will love this immersive children's performance that celebrates difference.

**TUE 15 SEP 10.30AM • TICKETS: \$10-\$15**



### BY A THREAD One Fell Swoop Circus

Be taken to new heights by this impressive display of acrobatics that will keep you on the edge of your seat.

★★★★★ Arts Hub

**SAT 10 OCT 7.30PM • TICKETS: \$23-\$28**

Bookings: **3829 8131** or [www.rpac.com.au](http://www.rpac.com.au)

Booking fees: \$4.30 by phone and \$5 online per transaction  
Dates subject to change

MILKE



**redland**  
performing arts centre



# STOP THE BAGGING. RED-LID THESE BAD BOYS!



## RECYCLING DOESN'T BELONG IN A PLASTIC BAG

Keep your recycling items separate in your yellow-lid bin. Don't throw out all your great recycling efforts because of a plastic bag. Not all plastic can be recycled kerbside and kitchen tidy bags or garbage bags are included in the bad boys list.

**IT'S IN OUR NATURE** ...to recycle right

 **Redland recycling**

 **3829 8999**



\*Not all residents have a red-lid general waste bin. A red-lid bin refers to the general waste bin, which maybe a dark green lid for some residents.



# WATCH OUT FOR THESE GUYS!

These bad boys have been playing havoc with Redlands Coast's recycling efforts and Redland City Council needs your help to give them some serious redirection.

The likes of Nasty Nappy and Obnoxious Onion and his food scrap gang have been increasingly getting into household recycling bins and damaging Council's efforts to make the most of the 12,000 tonnes of recyclable waste collected each year.

Council wants these bad boys safely confined ... in your red-lidded bin! To enlist your help, it has launched a new campaign called "It's in our nature" to remind residents what should go where when it comes to waste – and how that recyclable milk bottle or aluminium can will come back full circle into your fridge as a new packaging item.

We live in such a naturally wonderful place and Council knows it's in our nature to want to get our recycling right and ensure the bad boy gang – which includes the likes of plastic bags, food scraps, nappies, cereal box liners, chip packets (even when they look like foil), frozen veggie packets, old clothes and household batteries – get what's coming: and that's your red-lidded bin.



Find out more by going to [redland.qld.gov.au/waste](http://redland.qld.gov.au/waste)



## Brrrr... it's cold outside

### Stay in with Redland Libraries

Access our amazing FREE digital library anywhere, anytime:

- Ebooks, audiobooks, magazines, music and movies
- Online learning for adults and children
- Children's programs and storytelling

Stay up-to-date! Follow Redland Libraries on Facebook for online storytime sessions, latest library news and events and book reviews.

[f /redlandlibraries](https://www.facebook.com/redlandlibraries) [redland.qld.gov.au/libraries](http://redland.qld.gov.au/libraries) [3829 8999](tel:38298999)

01311 07/20



# We're back!

## Live performances return to the Redland Performing Arts Centre stage

Familiar faces and new talent will be in the spotlight as the Redland Performing Arts Centre (RPAC) brings live entertainment back to the stage.

With a comprehensive industry-specific COVID plan in place, patrons from Redlands Coast and further afield were welcomed back to the venue with a new *RPAC LIVE* concert series in July following the easing of restrictions.

The initiative was an opportunity to showcase and celebrate the best of local Redlands Coast's musical talent. As we head into spring we will see fan favourites and emerging talent gracing the stage as RPAC keeps the live entertainment flowing.

After the challenges of recent months, a good laugh is definitely in order, and this will be delivered with gusto when *Fat Musicals* takes a satirical look at musical theatre and its greatest (thinnest) leading ladies. Jimeoin will also have you in fits of laughter with his clever and quirky observations on everyday life when he performs *Ramble On* with his trademark devil-may-care style.

Whether you love classical music or classic hits, you can also look forward to great musical performances before the end of the year. Black Square Quartet will treat you to an afternoon of exquisite chamber music when they perform *Three by Five*, which features three, five-movement suites inspired by dance. *Rockin' Through the Ages* will take you on a nostalgic trip down memory lane with some of the greatest number one hits of all time from Elvis Presley, Roy Orbison, Neil Diamond, Tom Jones, The Monkees, Dr Hook and many more.

Young children and their families can also look forward to their share of entertainment when *Wilbur the Optical Whale* brings the friendliest giant in the sea to the stage to celebrate difference. *The Gruffalo's Child* will also take our littlest theatre-goers on a monster of an adventure when the Gruffalo's child heads into the deep, dark woods.

Circus and acrobatics will make a welcome return to the stage when One Fell Swoop Circus impresses you with their acrobatic skills in *By a Thread*. This "intricate and mesmerising show" (Arts Hub) will have you on the edge of your seat, as seven acrobats take you to new heights with their breath-taking dynamics. Budding acrobats can also look forward to the return of the Flipside Circus' school holiday workshops, with their circus skills classes for children from 4 to 16 years of age.

These are just some of the great performances and events you can look forward to at RPAC in the next few months. Many of the shows planned for 2020 have also been rescheduled to 2021, so make sure you visit the RPAC website at [www.rpac.com.au](http://www.rpac.com.au) for full details of shows coming soon.



*By a Thread.*  
Photo: Aaron Walker



*Rockin' Through The Ages*



*Black Square Quartet*



*Wilbur the Optical Whale*



*Fat Musicals*



*The Gruffalo's Child.*  
Photo: UK cast © Tall Stories



Jimeoin



## UPCOMING EXHIBITIONS



**CL 9 AUGUST – 6 SEPTEMBER**

**Port**  
Damien O'Mara

**Contested Landscapes**  
Dennis McCart

**CA 18 JULY – 1 SEPTEMBER**

**Placemaking**  
Sarah Sculley and Lara Furst

Images (left to right): Damien O'Mara, *Bunga Kelana 8* (detail) 2019, inkjet print on photorag. Courtesy of the artist. Dennis McCart, *Some kind of nature* (detail) 2019, oil on linen on hardboard. Courtesy of the artist. Sarah Sculley and Lara Furst, *Placemaking landscape* (detail) 2019, mixed media. Courtesy of the artists.

**Redland Art Gallery, Cleveland**  
Cnr Middle and Bloomfield Streets,  
Cleveland Q 4163

**Redland Art Gallery, Capalaba**  
Capalaba Place, Noeleen Street,  
Capalaba Q 4157

For more information and opening hours  
visit: [artgallery.redland.qld.gov.au](http://artgallery.redland.qld.gov.au)  
telephone: (07) 3829 8899 or  
email: [gallery@redland.qld.gov.au](mailto:gallery@redland.qld.gov.au)



**REDLAND ART  
GALLERY**

*Redland Art Gallery is an initiative of Redland City Council,  
dedicated to the late Eddie Santagiuliana.*



# Oh my word!

*The free membership that opens a world of possibilities*



There is a membership available to Redlanders that is totally free yet opens the doors to arguably the city's most valuable resource - your local library.

The crews at Redlands Coast's three mainland libraries – Cleveland, Capalaba and Victoria Point – along with the island and mobile services offer residents access to a world of knowledge and entertainment, as well as a great way to connect with your community.

It is easy to join for free either online at [redland.qld.gov.au](http://redland.qld.gov.au) or by visiting a branch.

There are no age limits and parents can join their children from the day they are born, with Redlands Coast's libraries running an amazing program of engaging and fun children's activities.

There's also a range of activities and programs for all ages, from story time for children to hearing your favourite authors talk about their latest works.

You can get more details of events at your local branch, along with a copy of the latest "hot read", including fiction, non-fiction, reference, large-print, graphic novels, magazines and newspapers, DVDs, CDs and audio books.

Your library can be a treasure trove for people interested in genealogy and local history.

Redlands Coast libraries offer fast and easy checkouts and returns, with library crew members on hand to help.

So even if you simply have a burning question, why not ask a librarian?



## Did you know?

- You can borrow up to 20 items per card for four weeks.
- If your library doesn't have the book you are after, you can ask for it to be bought or borrowed from another library.
- E-books, e-magazines and audio books are available to download for free around the clock, every day of the week.
- There are resources and support for languages other than English and for those learning a new language.
- There are multiple copies of books for book clubs.
- You can put items on hold and collect them from any branch or the mobile library.
- You can access computers, printing and photocopying services.
- Free Wi-Fi is available in air-conditioned spaces.
- You can access spaces for co-working, study and family time.



# ARE YOU READY REDLANDS COAST?

Prepare  
your home  
and family  
emergency  
plan

## BUSHFIRE AND STORM SEASON

### Prepare your home

- Clean gutters and downpipes so stormwater can drain quickly
- Secure loose items around your property and garden
- Trim trees and overhanging branches around your property (check with Council first)
- Install metal screens or shutters to prepare your home against embers
- Ensure LPG cylinder relieve valves point away from the house to minimise fire risk
- Make sure pumps or generators are working and ready if needed

### Make a household emergency plan

- Prepare an emergency kit with essentials such as medications, legal papers, first aid, a battery operated radio, batteries, pet food, money and a torch
- Have a good supply of bottled water readily available
- Identify a safe place to shelter in a storm or to evacuate to in a bushfire and decide how you'd look after your pets
- Decide whether to go early or stay and defend in bushfire situations
- Make sure everyone in your household knows your emergency plan

### For weather and warning updates:

- Bureau of Meteorology [bom.gov.au/qld](http://bom.gov.au/qld)
- Visit [ruralfire.qld.gov.au](http://ruralfire.qld.gov.au) for more information



[disaster.redland.qld.gov.au](http://disaster.redland.qld.gov.au)



RedlandCouncil



Tune to ABC 612 AM and 100.3 Bay FM



RedlandCouncil



[emergency@redland.qld.gov.au](mailto:emergency@redland.qld.gov.au)



Council 3829 8999

get  
**ready**  
QUEENSLAND



# Reconnect WITH NATURE



Explore the natural playground on your own backdoor. North Stradbroke Island (Minjerribah) offers the perfect day trip, short stay or extended holiday destination to reconnect with nature and indulge in an idyllic island experience. The best part is you don't have to travel far to feel like you are a million miles away.

Book your North Stradbroke Island (Minjerribah) getaway now. It's the perfect place to reconnect.

Deadman's Beach Rockpools

📍 North Stradbroke Island (Minjerribah)

[visitredlandsc coast.com.au](http://visitredlandsc coast.com.au)



Redlands  
c o a s t